

**FBT**

# VERTUS

CLA 112S



**IP55**



Sound Reinforcement  
Subwoofer

CODE: 46843\_rev.2  
#10-2024

ITA / MANUALE D'USO  
ENG / OPERATING MANUAL



# VERTUS

CLA 112S

<b>SAFETY PRECAUTIONS .....</b>	<b>14</b>
Important safety instruction .....	14
Precautions .....	14
<b>GENERAL FEATURES .....</b>	<b>15</b>
Description.....	15
Specifications.....	15
<b>DIMENSIONS.....</b>	<b>16</b>
<b>INPUTS &amp; OUTPUTS.....</b>	<b>17</b>
Barrier terminal block connector.....	17
<b>ACCESSORY.....</b>	<b>18</b>
<b>TECHINICAL SPECIFICATIONS.....</b>	<b>19</b>
<b>WASTE &amp; DISPOSAL.....</b>	<b>21</b>
Product specifications.....	21
Packing specifications.....	21

## General informations



### VERTUS CLA 112S Manual

Version: 2 ita, en | 10-2024 Code: 46843

#### MADE IN ITALY

Keep this document in a safe place so that it is available for future reference. We recommend you to regularly check the FBT website for the latest version of this document. When reselling this product, hand over this document to the new owner. To use the system properly, always consult the specific guides available on the product pages of the FBT website.

FBT Elettronica SpA - 62019 Recanati (Italy)  
www.fbt.it | info@fbt.it



**WARNING**  
**RISK OF ELECTRIC SHOCK**  
**DO NOT OPEN**



TO REDUCE THE RISK OF ELECTRIC SHOCK DO NOT REMOVE COVER (OR BACK) NO USER SERVICEABLE PARTS INSIDE REFER SERVICING TO QUALIFIED SERVICE PERSONNEL. TO REDUCE THE RISK OF FIRE OR ELECTRIC SHOCK DO NOT EXPOSE THIS EQUIPMENT TO RAIN OR MOISTURE.



This product conforms to applicable EU directive requirements.



This product conforms to all applicable UK regulations.

All informations included in this operating manual have been scrupulously controlled; however FBT is not responsible for eventual mistakes. FBT Elettronica SpA has the right to amend products and specifications without notice.

**Important safety instruction**



- Loudspeaker lines (amplifier outputs) can have a sufficiently high voltage (i.e. 100V) to involve a risk of electrocution; never install or connect this loudspeaker when the line is alive.
- Make sure all connections have been made correctly and the loudspeaker input voltage (in a constant voltage system) or its impedance is suitable for the amplifier output.
- Protect loudspeaker lines from damage; make sure they are positioned in a way that they cannot be stepped on or crushed by objects.
- To prevent inductive effects from causing hum, noise and a bad system working, loudspeaker lines should not be laid together with other electric cables (mains), microphone or line level signal cables connected to amplifier inputs.
- Never attempt to carry out any operations, modifications or repairs that are not expressly described in this manual. Contact your authorized service centre or qualified personnel.
- Also check the suitability of the support surface to which the product is anchored (wall, ceiling, structure, etc.) and the components used for attachment ( screws, screw anchors, etc.).
- Use only the optional devices / accessories specified by the manufacturer.
- Never use the handles, brackets or other elements of the module to directly suspend the modules or the system.

This manual contains important about the correct and safe use of the device. Before connecting and using this product please read this instruction manual carefully and keep it on hand for future reference. The manual is to be considered an integral part of this product and must accompany it when it changes ownership as a reference for correct installation and use as well as for the safety precautions. FBT SpA will not assume any responsibility for the incorrect installation and/or use of this product.

**Description**

Sleek and minimalistic lines distinguish the VERTUS CLA 112S, the new high excursion custom 12" passive subwoofer with 3" voice coil, IP55 weather resistant certification. The elegant design of the cabinet is completely built from solid watertight aluminum which protects the low-frequency woofer from infiltrations of dust and water such to damaging the correct functioning of the speaker. VERTUS CLA112S an 8Ohm nominal impedance with omnidirectional sound dispersion. It comes with a 4-pin Barrier terminal block connector and is available in different versions to color with textured paint. Requested external crossover and a 600W RMS recommended amplifier.

**Specifications**

- 1-way configuration
- Low-frequency woofer 12" with 3" voice coil
- 8Ohm nominal impedance
- Omnidirectional dispersion
- 600W RMS recommended amplifier
- Frequency response 40Hz - present dependent
- 4-pin Barrier terminal block connector
- Aluminum cabinet (0.31")
- IP55 weather-resistant certification - Type B
- 2 x ground mouth bracket (optional accessory)
- Textured paint
- Available in white (code 46115), black (codice 46116), or RAL (optional)

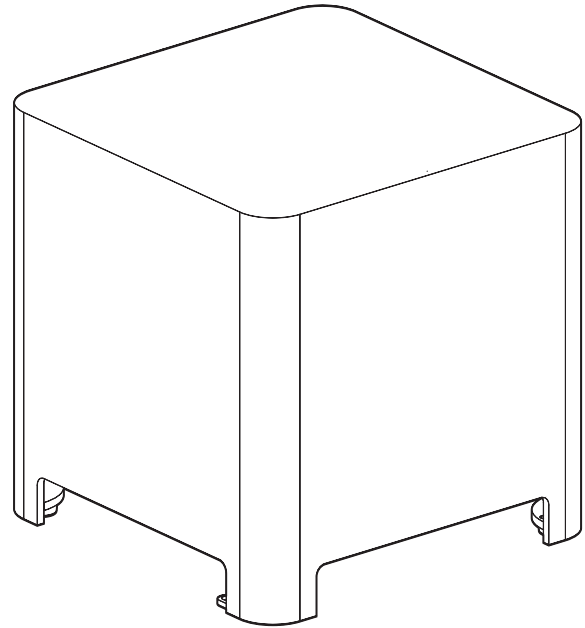

**Weather resistant**

**ONLY FOR GROUND STACK CONFIGURATION**

**⚠ WARNING** | FBT ELETTRONICA SpA accepts no responsibilities for any possible damages or injuries due to the use of supports or structures not strong enough or due to wrong installation.

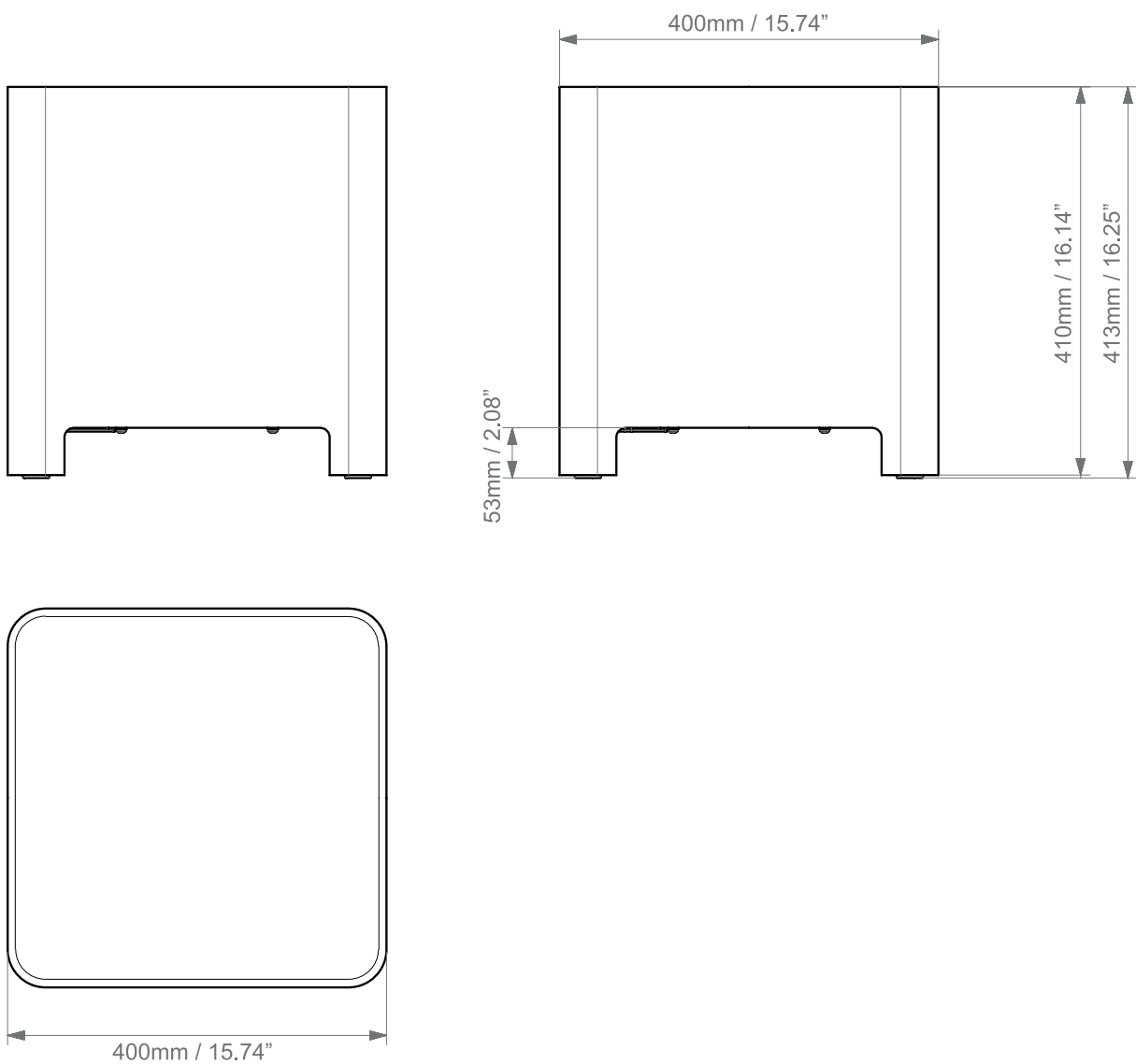

**Barrier terminal block connector**

Connect the positive wire (amplifier "+" output) to the pin "INPUT +" of the 4-pin EUROBLOCK connector.  
 Connect the negative wire (amplifier "-" output) to the pin "INPUT -" of the 4-pin EUROBLOCK connector. The "LINK +" and "LINK -" pins are useful to link another loudspeaker in parallel.

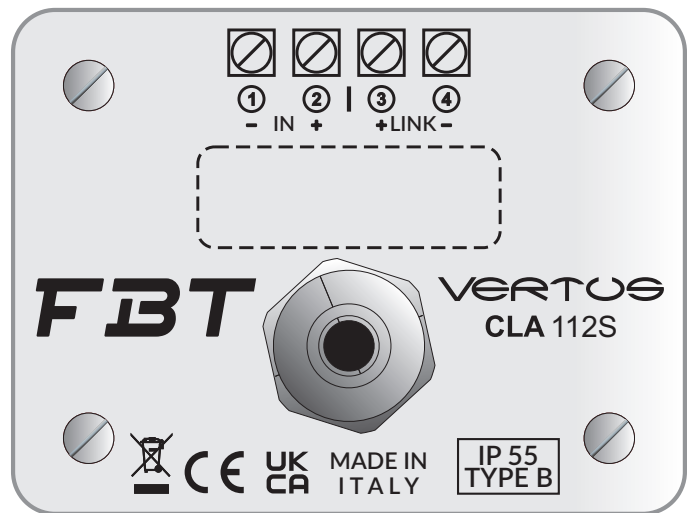
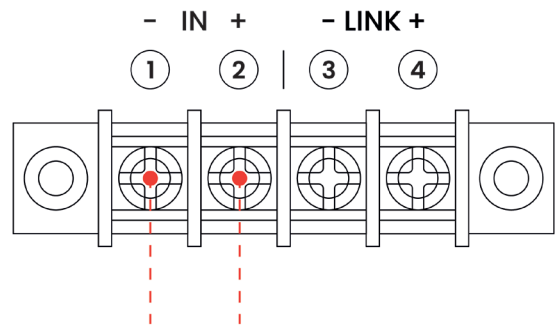
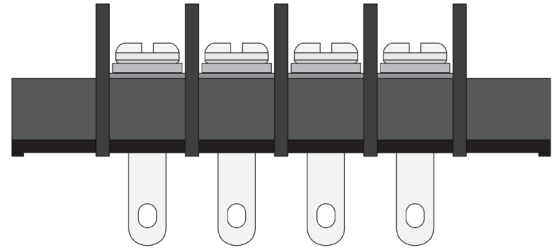

**Precautions**

- FOR VERTUS CLA 112S GROUND CONFIGURATION ONLY.
- Before proceeding with the installation, ensure that the surface is suitable and capable of supporting the weight and stresses of the device.
- For bracket mounting, use only the specific mounting holes on the subwoofer, as shown in the figure.
- During installation, make sure that all screws and bolts are tightened to the correct torque.
- After completing the installation, perform a final check to ensure that no components are loose, thus ensuring the safety and stability of the assembly.
- FBT ELETTRONICA SpA disclaims any liability for damages or injuries caused by supports/structures, an incorrect choice of mounting location, improper installation, or improper use of the product.

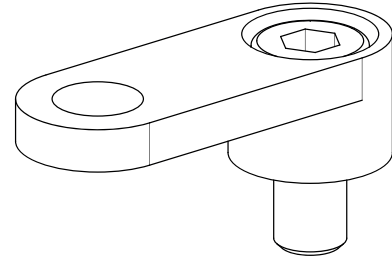
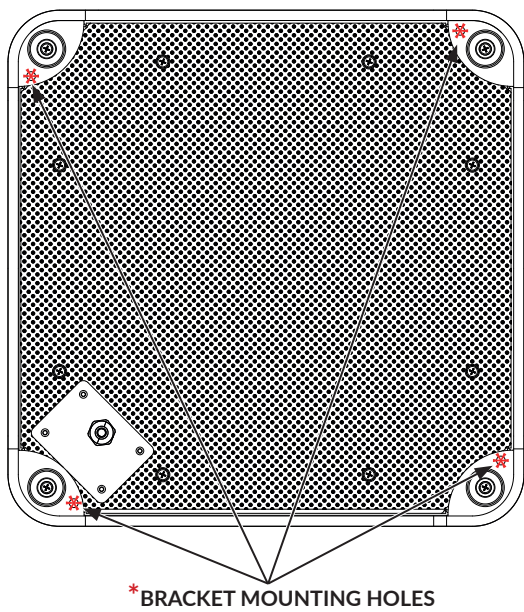

**ANTI-THEFT BRACKET**

Code: 47402

Stainless Steel

53 x 19 x 18mm

2.08 x 0.74 x 0.70inch

**Dimensional drawing**

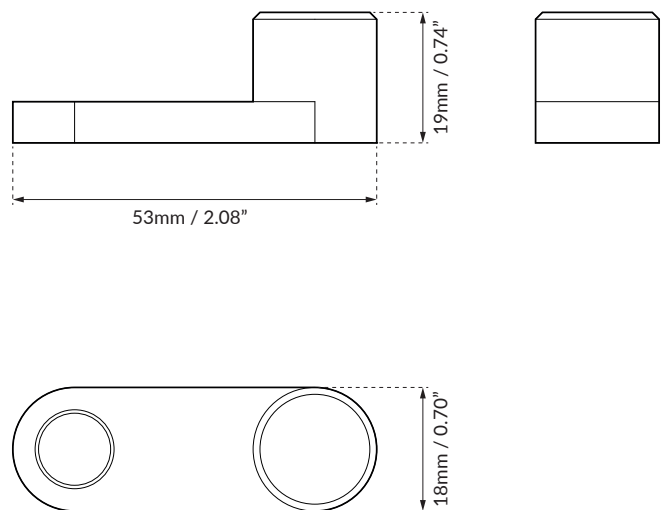



**INSTALLATION**

1. Use the subwoofer's mounting holes to attach the anti-theft bracket, using the provided M8x30 screw.
2. Ensure that the screw is tightened securely.
3. To provide additional security and stability, apply thread-locking adhesive.
4. Rotate the anti-theft bracket to the desired position.
5. Secure the subwoofer to the ground or supporting surface using an M8 or M10 threaded rod, anchored in the ground with anchors.

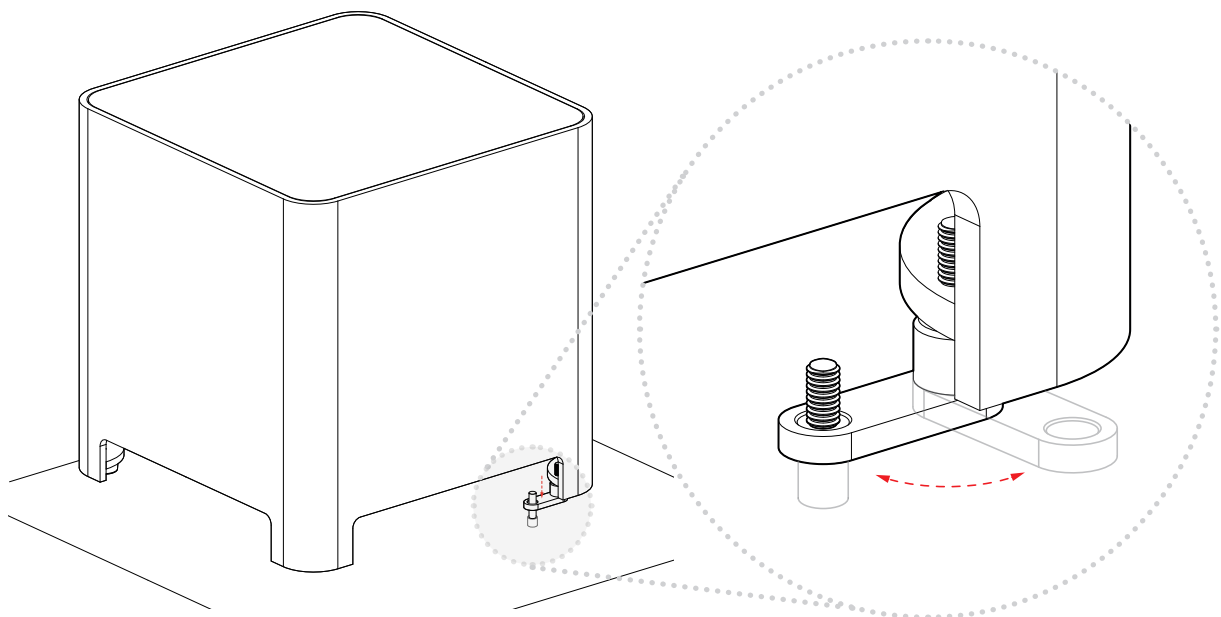
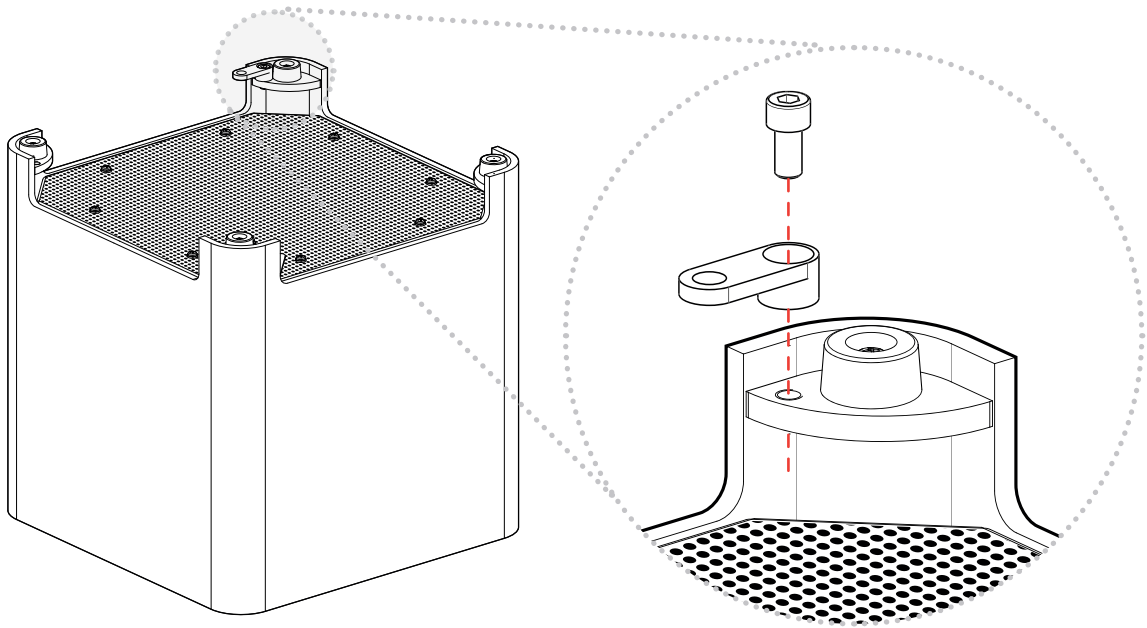

**GENERAL**

Code	Black	46116
	White	46115
Configuration	way	1
Low frequency woofer	inch	12 - 2.5 coil
High frequency driver	inch	---

**ACOUSTIC SPECIFICATIONS**

Frequency response (@-6dB)	Hz	40 - preset dependant
Sensitivity (@1W/1m)	dB	96
MAX SPL (@1m/4m)	dB	127 / 130
Dispersion	H° x V°	Omnidirectional
Recommended HP filter	Hz - 24 oct	35 - 24
Recommended external filter		Authorized FBT preset for digital processor or processed amplifier

**INPUTS & OUTPUTS**

Input connectors		4-pin Barrier terminal block
------------------	--	------------------------------

**AMPLIFIER**

Recommended amplifier	W RMS	600
Long term power	W	300
Short term power (IEC 268-5)	W	1200
Nominal impedance	Ohm	8

**MECHANICAL SPECIFICATIONS**

Material	Cabinet	Aluminium
	Grille	Aluminium
Net dimensions (WxHxD)	mm	400 x 410 x 400
	inch	15.74 x 16.14 x 15.74
Transport dimensions (WxHxD)	mm	465 x 475 x 460
	inch	18.3 x 18.7 x 18.11
Net weight	kg	25
	lb	55.11
Transport weight	kg	27.5
	lb	60.62

**Product specifications**

Where affixed on the equipment or package, the barred waste bin sign indicates that the product must be separated from other waste at the end of its working life for disposal. At the end of use, the user must deliver the product to a suitable recycling centre or return it to the dealer when purchasing a new product.



Adequate disposal of the decommissioned equipment for recycling, treatment and environmentally compatible disposal contributes in preventing potentially negative effects on the environment and health and promotes the reuse and/or recycling of equipment materials. Abusive product disposal by the user is punishable by law with administrative sanctions.



Check the instructions of your municipality. Separate the components and dispose them properly.

**AVOID RELEASE TO THE ENVIRONMENT**



**SCAN FOR RECYCLING INFO**

PLEASE FOLLOW YOUR AREA DISPOSITION

<https://docs.fbt.it/filebrowser/share/I2CuWax->



**Packing specifications**



**BOX**

Corrugated Cardboard

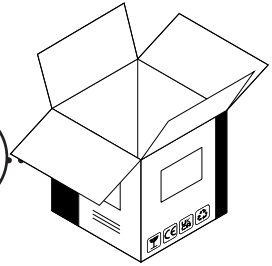

**PAPER DISPOSAL**

**PROTECTIONS**

Honeycomb Cardboard

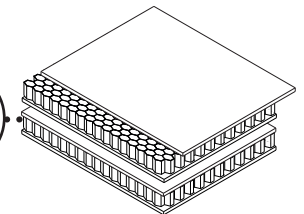

**PAPER DISPOSAL**

**BAGS**

Low-density Polyethylene

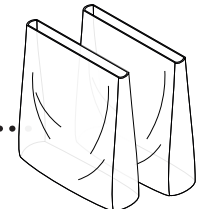

**PLASTIC DISPOSAL**

**MANUAL**

Paper

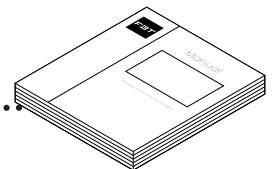

**PAPER DISPOSAL**







**FBT ELETTRONICA SPA**

Via Paolo Soprani 1 - 62019 RECANATI - Italy

Tel. 071750591 - Fax. 071 7505920

email: [info@fbt.it](mailto:info@fbt.it) - [www.fbt.it](http://www.fbt.it)